

TROUBLE SHOOTING GUIDE



INDEX

BAD WEATHER CONDITIONS

page 3

CLOSURE OF THE AWNING

page 3

LEAD BAR NOT CLOSING ON THE SIDE OPPOSITE THE WINCH

page 4

CHANGING THE CANOPY

page 5

ARMS REGULATION

page 6

REPLACEMENT OF THE DUAL SHOCK-ABSORBER

page 7

Please roll up your awning in case of rain, wind or snow. Otherwise, please take the following precautions: lower one side of your awning, so that water can flow away and assemble the tension rafter as shown in the figure (not included for all awning lengths).

BAD WEATHER CONDITIONS

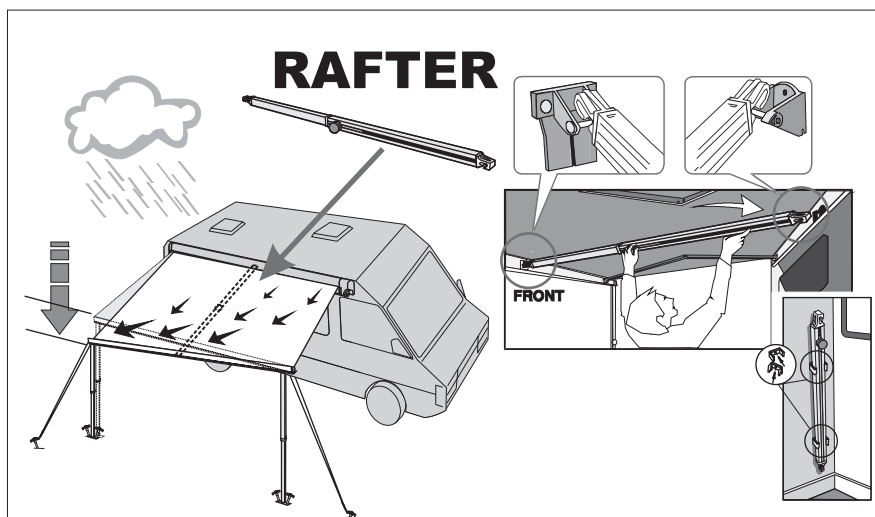

CLOSURE OF THE AWNING

Make sure that the awning perfectly rolls up: when it is, the red flag on the front profile ends are no longer visible.

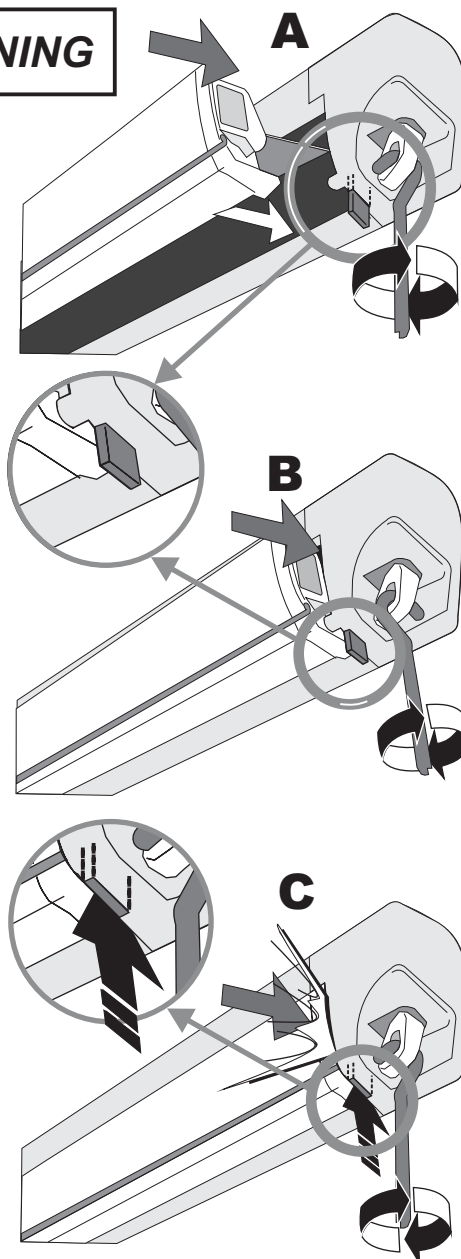

The awning is open.
The red flag is visible.

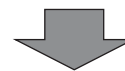

The awning is about to close.
The red flag is visible.

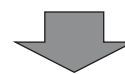

When the awning is completely closed, the red flag is no longer visible.
The awning is now properly closed.
The closure runs smoothly without problems.

LEAD BAR NOT CLOSING ON THE SIDE OPPOSITE THE WINCH

ROLLER REGULATION CAP PRESTO FIX

All Fiamma awnings are properly adjusted. However, over a period of time, the canopy could loose on the sides and the closing could be not perfect. Only for this problem you can work properly on the roller regulation cup PRESTO FIX (following the pictures) and the canopy's closing will be perfect. We suggest to use the roller regulation cup with moderation.

A



PROBLEM- Lead Bar does not close on the side opposite the winch

Unroll the awning completely

B

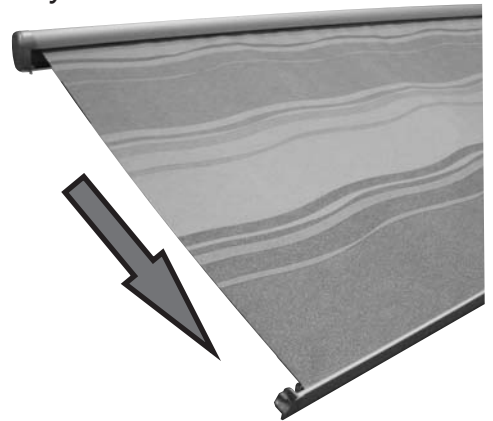

C

Work with a screwdriver on the ruller regulation cup

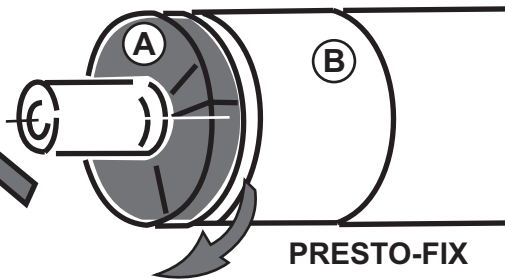

Operation way

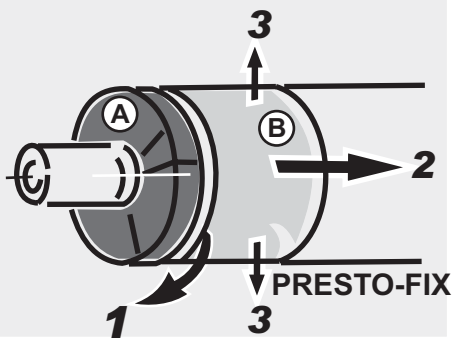

D

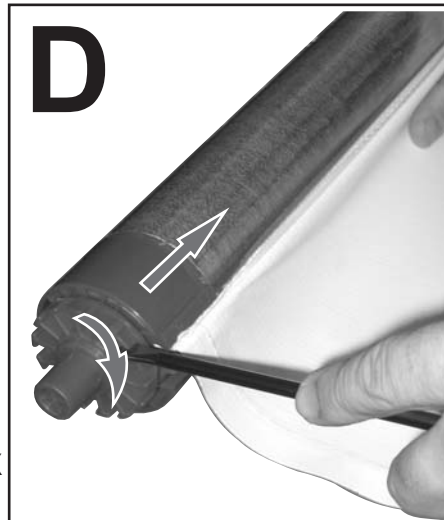

E

The awning closes again correctly

Rotate the nut (A) on a clockwise direction, the roller (B) is moving being more widen (see the picture)

CHANGING THE CANOPY



1 Remove both end caps with a screw driver.

2 Unroll the awning open about 30cm and remove the front screws on right side inner end cap. Remove screws on left side also.



3 Remove the case cover.

4 Loosen boltz on leg supports using a 13mm wrench and slide legs out of rail. Remove the screws which hold the canopy in the rail.

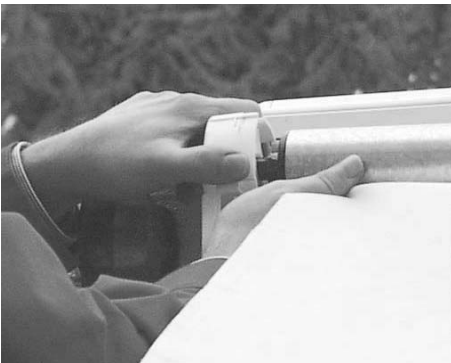

5 Loosen the screw on the left inner end cap and remove the roller tube.

6 Roll up the awning canopy on the roller tube completely, and slide the canopy out of the lead bar rail.



7 Slide the new canopy into the lead bar rail.

ARMS REGULATION

PROBLEM

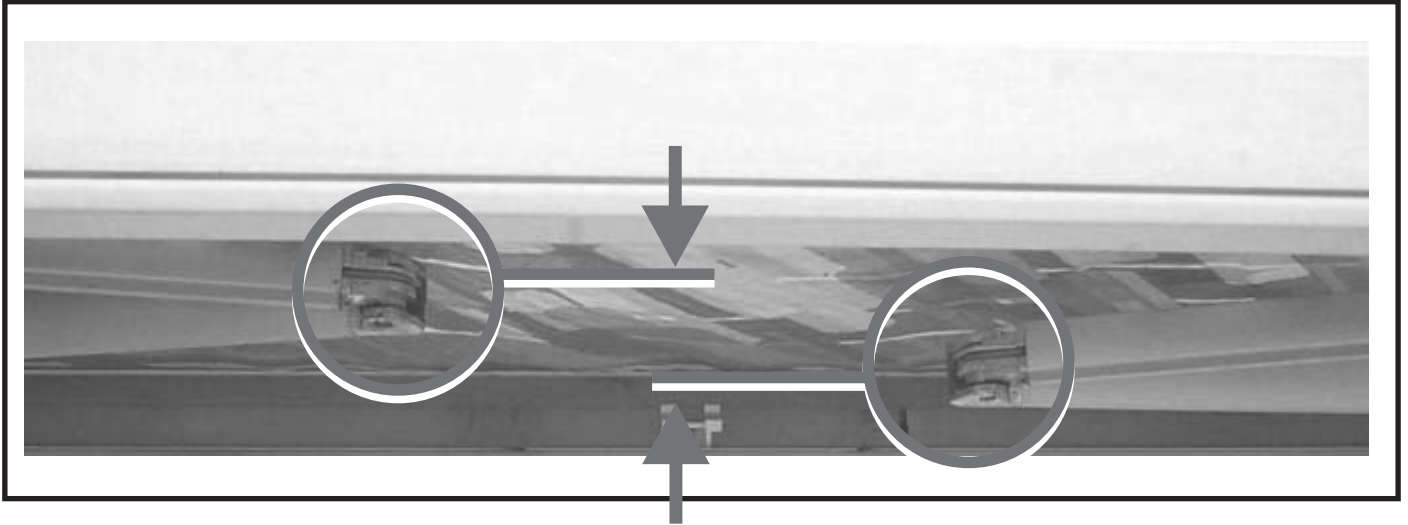

SOLUTION

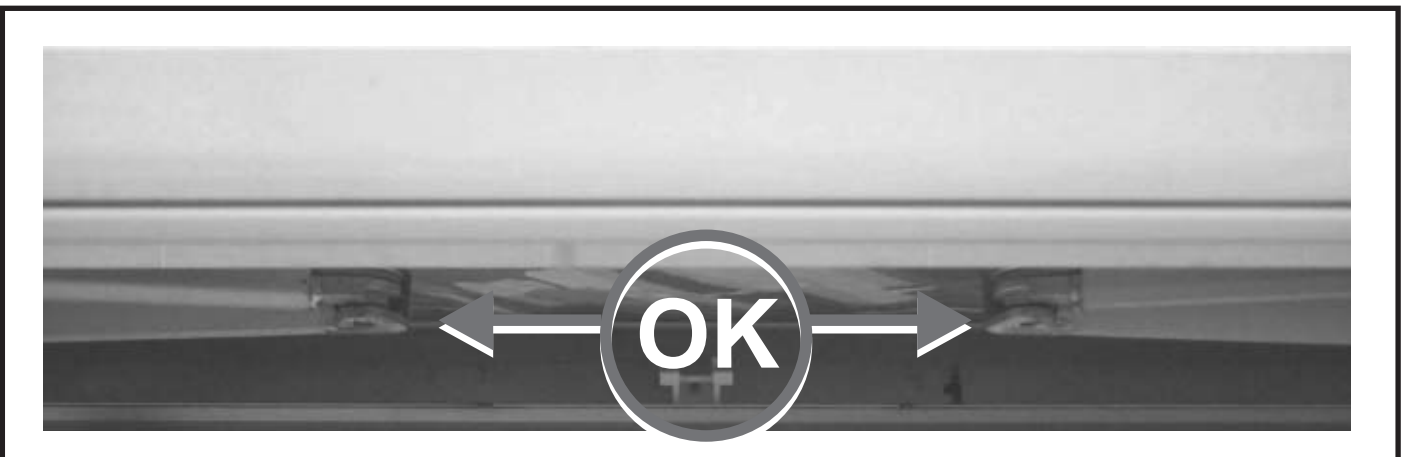
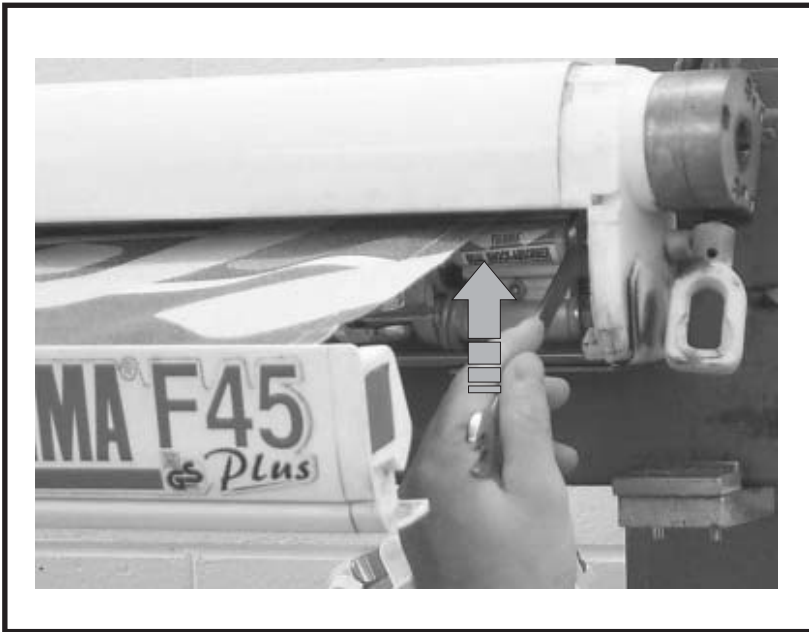

REPLACEMENT OF THE DUAL SHOCK-ABSORBER

The dual shock-absorber functions as a damper, and if it should break, serious damages on the awning are avoided.

Unroll the awning completely

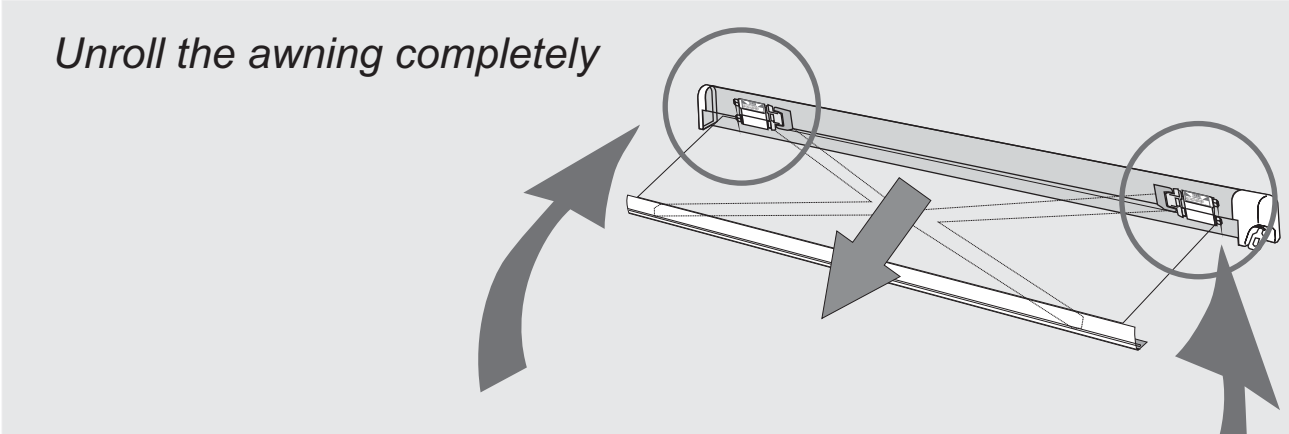

- 1 A hand is shown using a wrench with the number '13' on it to turn a nut on the shock absorber. An arrow points to the right, indicating the direction of rotation.
- 2 A hand is shown pulling the shock absorber out of its housing. An arrow points to the left, indicating the direction of removal.
- 3 A hand is shown pushing a new shock absorber into the housing. An arrow points to the right, indicating the direction of insertion.



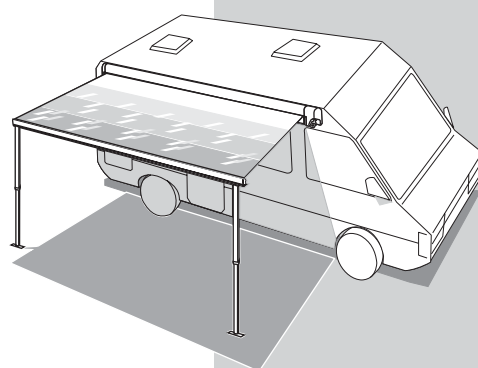

**Fiamma SpA - Milano Airport Highway
69, V. Europa - 21010 Cardano al Campo - ITALY
Fax +39 0331263777 fiamma.com**